



COPPUS Ventair[®] TM

High-pressure centrifugal blower/exhauster

MODEL/SPECIFICATIONS

ELECTRICAL SPECIFICATIONS

- Ventair models available with TE or EP (NEC classification) motors
- Single-phase (TM-4 only) specifications
- Multiple motor electrical classification

OPTIONS AND ACCESSORIES

- Motor starters
- Beaded or flanged diffusers
- Flexible duct
- Multiple inlet duct adapter
- Vibration isolators

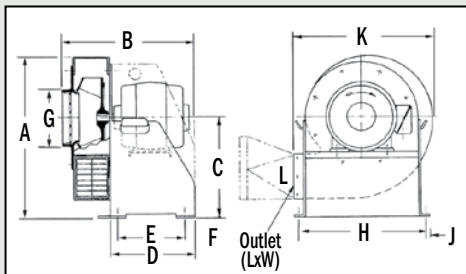

DESCRIPTION

This is a rugged, high-volume, high-pressure centrifugal fan. Backwardly inclined fan blades yield stable air flow through small diameter or long runs of duct. The high static pressure capabilities make this an ideal air mover for supplying fresh air or source-capturing welding and other fumes for multiple remote locations with optional, multiple inlet adapter.

NOTE: TM-5, TM-6, & TM-9 special order only.

FEATURES / ADVANTAGES

- Available in 1-, 2-, 5-, 15-, and 30-HP motors producing up to 10,700 cfm (18,179 m³/hr)
- One-piece, cast aluminum, spark-resistant, abrasion-resistant, dynamically balanced fan wheel
- Heavy-gauge steel housing and base protects fan and motor
- Backward curved airfoil-shaped blades provide non-overloading power characteristics allowing peak performance through long runs of duct
- TE and EP motors available
- 3,500 rpm motor directly connected to the fan wheel
- Variable outlet configuration



Optional four-inch (101.6 mm), multiple-duct adapter

DIMENSIONS

MODEL	in/mm										L (OUTLET) in/mm	WT lbs/kgs
	A	B	C	D	E	F	G	H	J	K		
TM-4	22.5 572	18.8 478	14.0 356	12.0 305	8.0 203	2.0 51	8.0 203	16.5 419	1.0 25	19.0 483	7.4 X 5.5 188 X 10	110 50
TM-5	26.2 665	23.6 599	16.5 419	15.0 381	11.7 298	1.5 38	10.0 254	19.5 495	1.0 25	22.0 559	8.7 X 6.6 221 X 168	130 59
TM-6	28.8 732	24.9 632	17.5 445	15.5 394	12.2 311	1.5 38	12.0 305	22.5 572	1.0 25	25.2 651	9.6 X 7.4 244 X 234	205 93
TM-8	35.6 904	32.6 828	22.0 559	21.0 533	16.0 406	2.0 51	14.0 356	28.8 734	1.5 38	30.0 762	11.5 X 9.2 292 X 234	550 250
TM-9	42.0 1,067	38.5 978	26.0 660	27.0 686	22.7 578	2.0 51	16.0 406	31.5 800	1.5 38	34.2 870	11.5 X 9.2 292 X 234	670 304

TECHNICAL DATA

FREE AIR DECIBEL LEVELS	
TM-4	84 dBA
TM-5	88 dBA
TM-6	94 dBA
TM-8	100 dBA

AIR DELIVERY AT 3,500 RPM							
MODEL	HP	FREE AIR		NOMINAL DUCT SIZE		STATIC PRESSURE to 24 inch WG max	
		cfm	m ³ /hr	in	mm	in	mm
TM-4	1	1,700	2,887	8	203	6.0	152
TM-5	2	2,500	4,248	10	254	8.2	208
TM-6	5	4,100	6,966	12	305	12.7	323
TM-8	15	7,450	12,658	14	356	18.6	472
TM-9	30	10,700	18,179	16	406	24.2	615



Mountain Controls



COPPUS®
Air Movers

Portable Ventilators
Fans & Blowers
Welding Fume Exhausters
Ducts



POWERS
PROCESS CONTROLS
Quality...Our Commitment

Control Valves – Globe Type
Temperature Regulators
Self-Contained Temperature Controllers



MARSH®

Pressure Gauges
Thermometers
Needle Valves and Diaphragm Seals



BELLOFRAM®
Precision Controls

Precision Air Regulators
Air, Gas, Steam & Water Regulators
Vacuum and Backpressure Regulators
I/P and E/P Transducers



RCS

Electric Actuators
Modulating Controllers
Spring Return – SURE
Mounting to your valves.



AT AT Controls, Inc.

Electric Actuators
Spring Return Electric Actuators



G C
VALVES

Solenoid Valves
Water – Air – Hot Water – Steam
Pilot Valves



MOORE INDUSTRIES
WORLDWIDE

Process Controllers
Multi-Loop Process Indicators with Switches



SVF
Flow Controls, Inc.

Ball Valves – 3-piece
Pneumatic Actuators
Electric Actuators
Specialty Valves

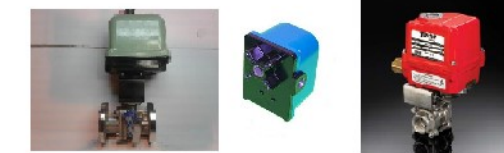

Custom Actuator Solutions

Electric actuators mounted and tested to the valve of your choice.
Custom lightweight actuators for compact solutions

Mountain Controls

Salt Lake City, UT 84109
Phone: 801-487-8795

Seattle, WA 98125
Phone: 206-316-2330

www.mountaincontrols.com

info@mountaincontrols.com